

FEMALE BRANCH TEE

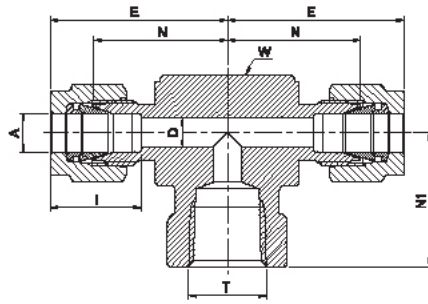

A Tube O.D.		T NPT	D		W Wrench flat		N		E		N1		I	
mm	in	in	mm	in	mm	in	mm	in	mm	in	mm	in	mm	
6		1/8	4.8		1/2		12.7		19.6		27.0		19.0	15.3
6		1/4	4.8		11/16		17.5		22.4		29.8		22.4	15.3
6		3/8	4.8		13/16		20.6		24.4		31.7		22.4	15.3
6		1/2	4.8		1		25.4		27.2		34.5		28.4	15.3
8		1/8	6.4		5/8		15.9		23.1		29.9		19.0	16.2
8		1/4	6.4		11/16		17.5		23.1		30.6		22.4	16.2
8		3/8	6.4		13/16		20.6		25.2		32.4		22.4	16.2
8		1/2	6.4		1		25.4		28.0		35.2		28.4	16.2
10		1/4	7.9		13/16		20.6		25.9		33.5		22.4	17.2
10		3/8	7.9		13/16		20.6		25.9		33.5		22.4	17.2
10		1/2	7.9		1		25.4		28.7		36.1		22.4	17.2
12		1/4	9.5		13/16		20.6		25.9		36.0		22.4	22.8
12		3/8	9.5		13/16		20.6		25.9		36.0		22.4	22.8
12		1/2	9.5		1		25.4		28.7		38.8		28.4	22.8
16		1/2	12.7		1		25.4		28.7		38.8		28.4	24.4

A Tube O.D.		T NPT	D		W Wrench flat		N		E		N1		I	
in	mm	in	in	mm	in	mm	in	mm	in	mm	in	mm	in	mm
1/8	3.17	1/8	0.09	2.28	1/2	12.7	0.70	18.00	0.97	24.64	0.75	19.05	0.50	12.7
1/4	6.35	1/8	0.19	4.82	1/2	12.7	0.77	19.56	1.06	26.96	0.75	19.05	0.60	15.3
1/4	6.35	1/4	0.19	4.82	11/16	17.5	0.88	22.35	1.17	29.71	0.88	22.35	0.60	15.3
3/8	9.52	1/4	0.28	7.11	11/16	17.5	0.94	23.88	1.23	31.24	0.88	22.35	0.66	16.9
1/2	12.70	1/4	0.41	10.41	13/16	20.6	1.02	25.90	1.42	36.07	0.88	22.35	0.90	22.9
1/2	12.70	3/8	0.41	10.41	13/16	20.6	1.02	25.90	1.42	36.07	0.88	22.35	0.90	22.9
1/2	12.70	1/2	0.41	10.41	1-1/8	25.4	25.4	28.70	1.53	38.86	1.12	28.45	0.90	22.9
5/8	15.87	1/2	0.50	12.70	1-1/8	25.4	25.4	28.70	1.53	38.86	1.12	28.44	0.96	24.4
3/4	19.05	3/4	0.62	15.74	1-3/8	34.9	1.36	34.50	1.78	44.70	1.25	31.75	0.96	24.5
1	25.40	3/4	0.88	22.35	1-3/8	34.9	1.45	36.83	1.93	49.02	1.25	31.75	1.23	31.2
1	25.40	1	0.88	22.35	1-11/16	42.9	1.63	41.40	2.11	53.60	1.50	38.10	1.23	31.2